

P.S.I.E.C

LAY-OUT PLAN OF INDUSTRIAL FOCAL POINT JULLUNDUR, (OLD)

- NOTE:-**
1. SALEABLE AREA INCLUDES AREA UNDER PLOT 50% AREA UNDER COMMERCIAL AND AREA UNDER PETROL PUMP AND AREA UNDER ELECTRIC SUB-STATION AND P&T DEPTT.
 2. ALL EXISTING 11 K.V. LINE ARE TO BE SHIFTED/ ADJUSTED.
 3. WATER WORKS AND DISPOSAL WORKS SITE ARE MARKED IN CONSULTATION WITH E.E.- 1, P.S.I.C. DATED 15.06.76.
 4. ARTISAN ESTATE IS DECLARED ONE KANAL PLOT HAVE BEEN CARVED OUT INSTEAD IN ACCORDANCE THE DECISION OF ALLOTMENT COMMITTEE HELD ON 23.01.1980 DATE OF AMENDMENT 17.03.1980.
 5. PLOT ARE NUMBERED ON 22.03.1978.
 6. PUMP CHAMBER, STAFF QUARTER AND MAINTENANCE OFFICE MARKED ON THE PLAN ON DATED 15.02.1979.
 7. STANDARD DESIGN FOR STAFF QUARTER SHALL BE AS PER THIS OFFICE DRG. NO. STD./STAFF QTR/ P.H.- 1/ 76.
 8. STANDARD DESIGN OF CHLORINATION CHAMBER AND TUBEWELL SHALL BE FOLLOWED.
 9. FOR ARCHITECTURE DETAIL OF MAINTENANCE OFFICE REFER DRG. NO. MISC./ OFFICE- 3/ 78 DATED 21.07.1978.
 10. PLOT NO. A-3 TO A-9 ARE READJUSTED ON DATED 03.05.1979 ACCORDING TO THE RECOMMENDATION OF ALLOTMENT COMMITTEE HELD ON 13.12.78. VIDE LETTER NO. KC/LMI/FP/ALLOT/JULLUNDURE/8535 DATED CHANDIGARH THE 27.04.1979.
 11. PLOT NO. A-10 TO A-15 HAVE BEEN ADJUSTED AS PER ACTUAL MEASUREMENT AT SITE ON 24.10.1979.
 12. PLOT NO. A-1, A-2 AND B-1 TO B-6 HAVE BEEN READJUSTED AS DECISION WITH CHIEF ENGINEER ON 14.11.1979. VIDE ENDORSEMENT NO. JULL/200400/A DATED 25.10.1979.
 13. TWO SITES (E-1A AND SITE ADJOINING PLOT NO. B-6) OF ELECTRIC SUB-STATION HAVE BEEN MARKED AS DISCUSSED IN THE MEETING WITH S.E. PSEB. JULLUNDUR ON 29.09.1980.
 14. ELECTRIC SUB-STATION SITE HAS BEEN MARKED AS PER THE LETTER RECEIVED FROM THE XEN U/E DIVISION SAS NAGAR VIDE MEMO NO. 6327 DATED 22.10.1980 DATE OF AMENDMENT 09.12.1980.
 15. DRAWING APPROVED BY C.T.P (PB.) VIDE MEMO NO. 1813 C.T.P. (PB.)/ SJ- 182 DATED CHANDIGARH THE 28.05.1979.
 16. DRAWING APPROVED VIDE D.T.P. JULLUNDUR DRAWING NO. D.T.P.- J 36/ 77 DATED 27.05.77.

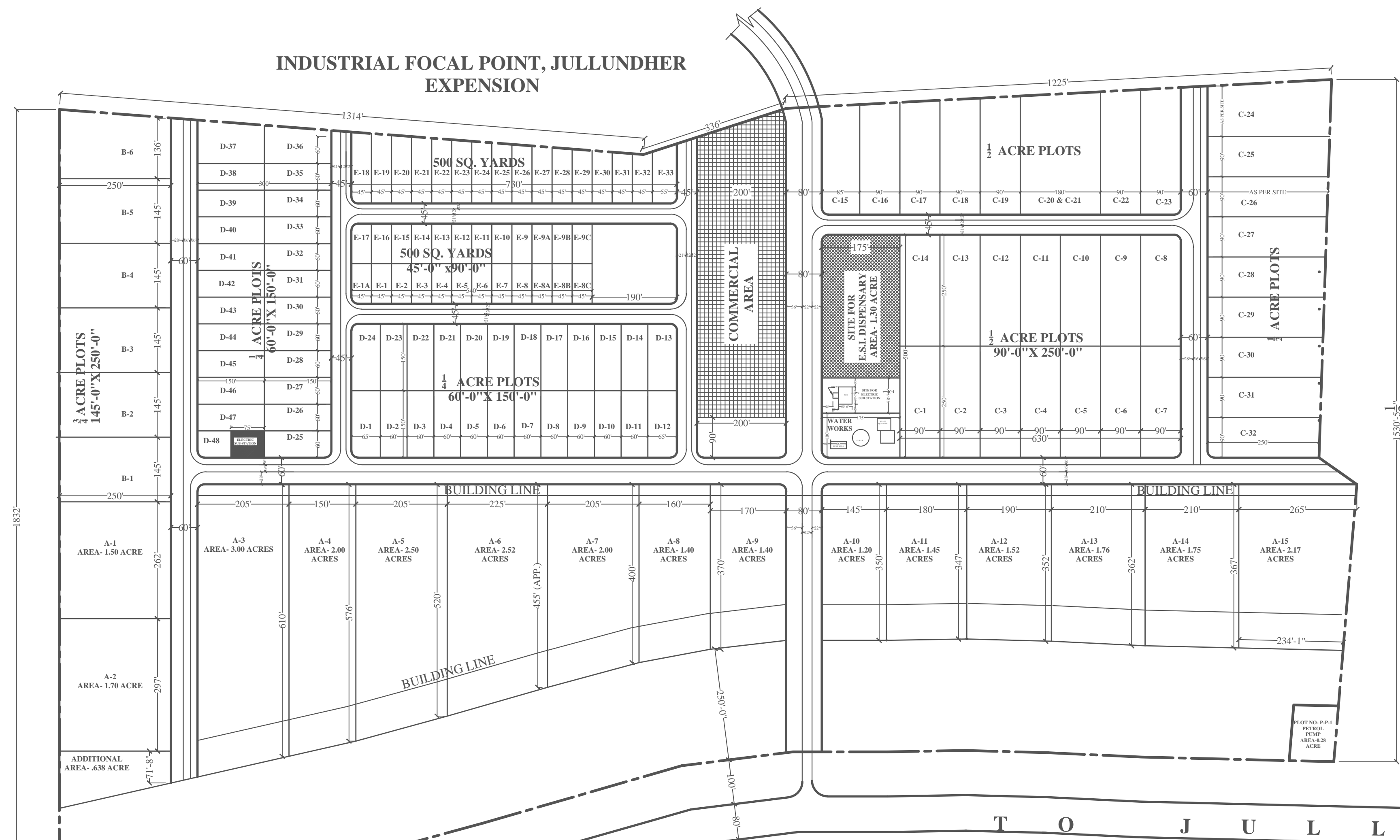

SCHEME DETAIL

TOTAL SCHEME AREA	105.00 Acres
-------------------	--------------

DETAIL OF PLOTS :-

S.NO.	CATEGORY	SIZE	NO OF PLOTS	AREA	
1.	1 Acres & Above	-	15	28.45 Acres	
2.	1/2 Acres Plots (145'-0" x 250'-0")	-	06	5.00 Acres	
3.	1/3 Acres Plots (90'-0" x 250'-0")	-	32	17.00 Acres	
4.	1/4 Acres Plots (60'-0" x 150'-0")	-	48	10.10 Acres	
5.	500 Sq. Yards Plots (45'-0" x 90'-0")	-	39	4.62 Acres	
TOTAL AREA				140	65.17 Acres

LAND ANALYSIS:-

S.NO.	CATEGORY	AREA
1.	AREA UNDER INDUSTRIAL PLOTS	65.17 Acres
2.	AREA UNDER ELECTRIC SUB-STATION	0.31 Acres
3.	AREA UNDER COMMERCIAL USE	3.35 Acres
4.	AREA UNDER PUBLIC BUILDING	1.44 Acres
5.	AREA UNDER PETROL PUMP	0.28 Acres
6.	AREA UNDER ROADS	17.50 Acres
7.	AREA UNDER P & T DEPARTMENT	0.78 Acres
8.	AREA UNDER WATER WORKS	0.40 Acres
9.	AREA UNDER DISPOSAL WORKS	0.91 Acres
10.	AREA UNDER GREEN BELT ALONG BYE PASS	14.16 Acres
11.	AREA UNDER RAW MATERIAL DEPOT	0.70 Acres
TOTAL		105.00 Acres

DETAIL OF SALEABLE AREA:-

1. AREA UNDER PLOTS	65.17 Acres	
2. 50% OF COMMERCIAL AREA OF 2.93 Acres	1.46 Acres	
3. AREA UNDER E.S.I. DISPENSARY	1.30 Acres	
4. AREA UNDER PETROL PUMP	0.28 Acres	
5. AREA UNDER P & T	0.78 Acres	
6. AREA UNDER ENGINEER EXPORT	0.41 Acres	
TOTAL		69.40 Acres

**OFFICE OF THE CHIEF ENGINEER,
PUNJAB SMALL INDUSTRIES & EXPORT CORPORATION**
18, HIMALAYAN MARG,
UDYOG BHAWAN, SECTOR 17-A CHANDIGARH

SCALE:- 1"=220'-0"	DRG. NO.:-
	DRAWN BY -s/d- CHECKED BY -s/d-

SUPERINTENDING ENGINEER :-
DRAWING PREPARED IN AUTO CAD
THIS DRAWING PREPARED ON THE BASED OF DRAWING NO.
DATED -

DILPREET PREPARED BY (J.D.M):-	SUKHDEV SINGH PLANNING OFFICER :-
-----------------------------------	--------------------------------------

**J.S. RANDHAWA
GENERAL MANAGER :-**

